

PLAN

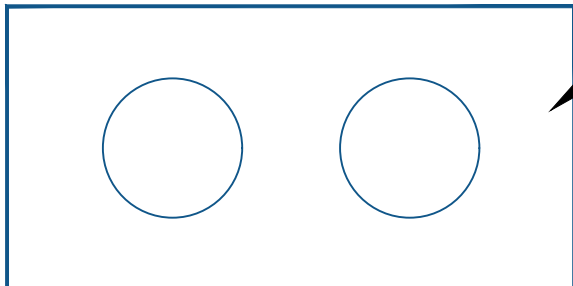

JUTA GP® TITANFLEX
PRE-FORMED PIPE COLLAR

JUTA HYDROLOCK STRIP
APPLIED AROUND PENETRATIONS

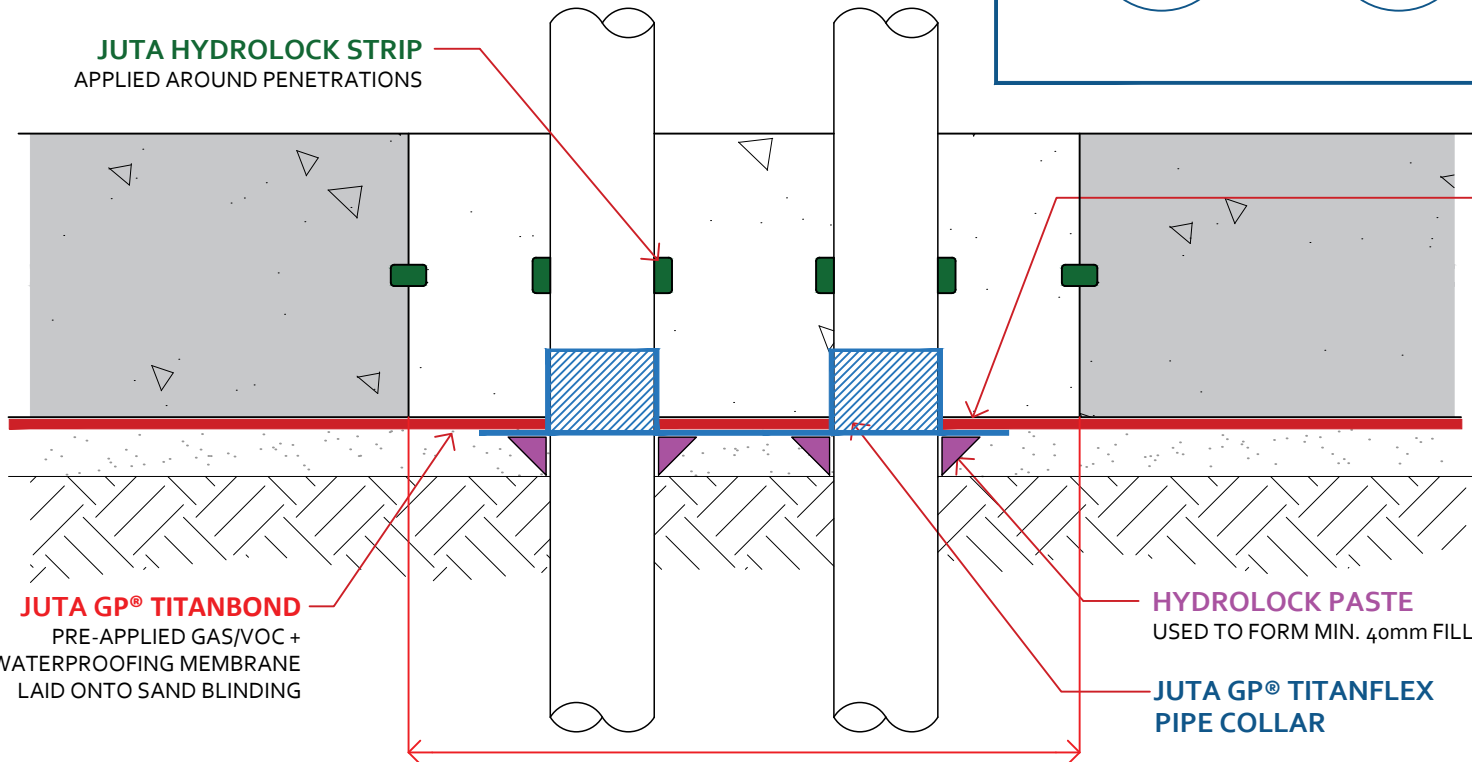

JOINT BETWEEN JUTA TITANBOND
AND PIPE COLLAR USING JUTA GP
TITAN TAPE OR WELDED

NB - TAPED JOINT TO BE USED
WHERE DESIGN LIFE DOES NOT
EXCEED 25 YEARS

WELDED JOINT TO BE USED WHERE
DESIGN SERVICE LIFE TO EXCEED 60
YEARS

JUTA GP® TITANBOND
PRE-APPLIED GAS/VOC +
WATERPROOFING MEMBRANE
LAID ONTO SAND BLINDING

HYDROLOCK PASTE
USED TO FORM MIN. 40mm FILLET

JUTA GP® TITANFLEX
PIPE COLLAR

BOX OUT IN SLAB

CLIENT
JUTA UK LTD

PROJECT
GP® TITANBOND - Standard Details



- NOTES
- Detail is generic to application so should not be used as a guide not a specific installation detail.
 - GP®TITANBOND is a TYPE A Waterproofing membrane, in accordance with BS8102:2009, suitable for Grade 1, 2 and 3 Basement constructions.
 - GP® TITANBOND is a proprietary gas and VOC resistant DPM, manufactured and certified to adhere to the requirements of BS8485: 2015+A1: 2019 and CIRIA C748: 2014, as a radon, carbon dioxide, methane and VOC barrier.
 - Jointing and sealing using tapes is acceptable where anticipated design service life does not exceed 25 years.
 - Jointing and sealing by hot air welding is recommended where the anticipated design service life is required to exceed 60 years.
 - The use of butyl and bitumen based tapes in environments where VOC and Hydrocarbons are a perceived risk should be avoided. A thermal/welded joint system should be adopted.
 - It should be noted that the suitability of the welded joint is defined by the joint integrity, as tested in accordance with CIRIA C735: 2014. This is most commonly tested by air lance integrity testing to ASTM D4437-08: 2013. If the joint passes this test it is deemed acceptable in the verification process.
 - In all cases it is recommended the installation of gas barrier geomembranes is completed by a suitably qualified and accredited installer (NVQ L2/TWI/CSWIP or equivalent). Juta UK can offer advice as to the suitable/recommended installers.
 - The gas protection system installation should be subject to third-party independent verification, in accordance with BS8485: 2015 +A1: 2019 and CIRIA C735: 2014.
 - All design decisions made by others that might have an impact on the gas and waterproof design performance should be brought to the attention of the design team and Juta UK Ltd. Final decisions and/or any recommendations should be approved by the design team and Juta UK Ltd.
 - Dimensions are not to be scaled from this drawing. All written measurements are to be checked on site by the contractor.
 - All rights described in chapter IV of the copyright, design and patents act 1988 have been generally asserted.

DRAWING TITLE
JUTA GP® TITANBOND
DOUBLE VERTICAL PIPE PENETRATION

DRAWING NUMBER
JUTA.TB.016

| | | | |
|----------------|------------------|-----------------------|-------------------|
| DRAWN BY PD | CHECKED BY PF | SCALE Not to Scale | DATE Dec. 2020 |
|----------------|------------------|-----------------------|-------------------|



MELTON GROVE WORKS
BLACKPOOL ROAD
LYTHAM
FY8 5PL
Tel: 01772 754177