

JUTA PD1700
 (PROTECT & DRAIN) APPLIED EXTERNALLY AS
 PROTECTION PRIOR TO BACKFILLING - TO BE
 EXTENDED DOWN TO LAND DRAIN

JUTA GP1® SAM
 APPLIED EXTERNALLY TO SLAB EDGE AND
 WALL PREPARED WITH 1 COATS OF JUTA
 GP PRIMER. EXTENDING UP TO DPC LEVEL

ALL CORNERS TO BE REINFORCED
 WITH A MIN. 40mm CEMENT FILLET
 AND 300mm WIDE REINFORCING STRIP
 OF JUTA GP SAM

GRANULAR FILL DRAINAGE
 BACKFILL MATERIAL

SUGGESTED MAINTAINABLE
 LAND DRAIN LOCATION AS
 BS8102:2009 RECOMMENDATIONS

JUTA GP® TITANBOND
 PRE APPLIED ONTO A SAND BLINDING
 BELOW THE SLAB. TO BE EXTENDED
 UP TO TOP OF CONCRETE POUR

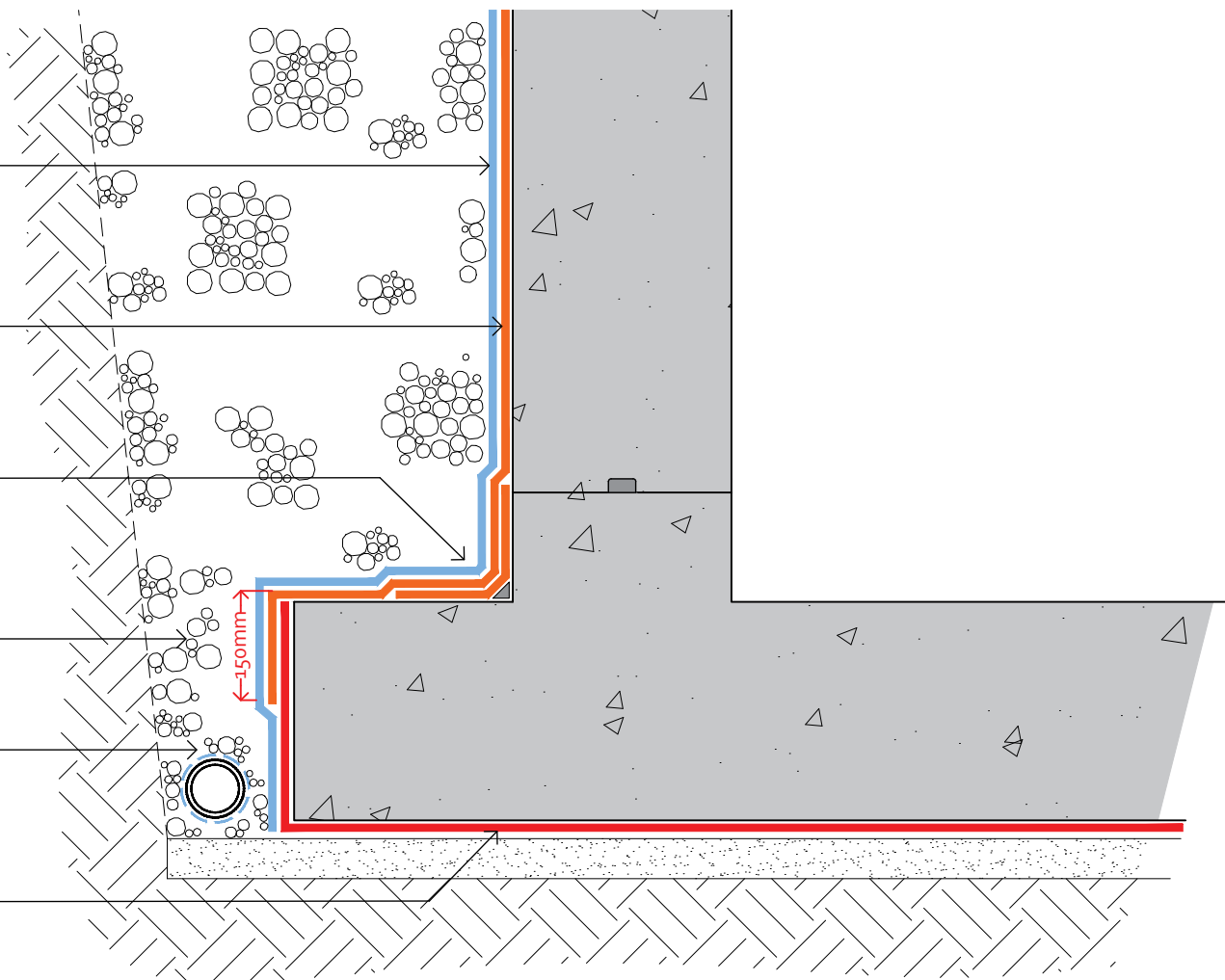

CLIENT
 JUTA UK LTD

PROJECT
 JUTA GP1® SAM Typical Details



NOTES

- Detail is generic to application so should be used as a guide not a specific installation detail.
- JUTA suggest that waterproofing membranes including JUTA GP1 SAM should be installed by suitably experienced persons. If unfamiliar with products and applications, please contact JUTA for Specialist Contractors Details.
- JUTA GP1 SAM can be applied to reinforced concrete, concrete blockwork and masonry. It can also be applied to various masonry wall systems (i.e. ICF or Stepoc.) but please contact JUTA or a specialist to confirm suitability of primers and adhesive on structure.
- All surfaces must be prepared with 1 coats of JUTA GP Primer before application. Please refer to JUTA SAM Installation Guide for further information
- All externally applied membrane should be protected from damage prior to backfilling. This can be achieved using standard protection boards or better still, JUTA PD1700 which is a protection and drainage sheet layer which additionally creates a void between the membrane and earth to reduce the change of hydrostatic pressure onto the structure and direct any groundwater to land drain locations.
- All design decisions made by others that might have an impact on the gas and waterproof design performance should be brought to the attention of the design team and Juta UK Ltd. Final decisions and/or any recommendations should be approved by the design team and Juta UK Ltd.
- Dimensions are not to be scaled from this drawing. All written measurements are to be checked on site by the contractor.
- All rights described in chapter IV of the copyright, design and patents act 1988 have been generally asserted.

DRAWING TITLE
**JUTA WP SAM (SELF ADHESIVE MEMBRANE)
 RC RETAINING WALL/ SLAB WITH TOE DETAIL**

DRAWING NUMBER
 JUTA.GP1-SAM.005

DRAWN BY PD	CHECKED BY PF	SCALE Not to Scale	DATE Mar. 2020
----------------	------------------	-----------------------	-------------------



MELTON GROVE WORKS
 BLACKPOOL ROAD
 LYTHAM
 FY8 5PL
 Tel: 01772 754177