



GP[®]1

GP[®]1 proprietary gas resistant damp proof membrane (DPM) is a multi-layer, low density polyethylene membrane, reinforced with a polypropylene reinforcing grid with an integral aluminium foil for protection against methane, carbon dioxide, radon, ground gas, air & moisture.

Features and benefits:

- High quality reinforced membrane.
- Low permeability to hydrocarbon and VOC vapours, carbon dioxide, methane and radon.
- Complies with latest codes of practice as published by the BRE and CIRIA, and BS 8485.

Can be used on any site in accordance with BS8485:2015 and NHBC requirements where carbon dioxide, methane or radon is present up to and including CIRIA 665 SITUATION 6. The barrier is sufficiently resistant to the ingress of harmful gasses into a building. On more heavily contaminated sites a passive or active venting system may be required to dilute the gasses down to acceptable levels and specific design advice should be sought.

Physical Properties

Thickness	0.6 mm
Width	2 m
Length	50 m
Weight	370 g/m ²

Gas Permeability

Methane	< 0.09
Carbon Dioxide	< 0.09
Radon	8.0 x 10 ⁻¹⁵

Compliance and Certification

CE MARK - EN13967:2015
NHBC Standards Compliant
B58485:2015 + A1 2019 Accordant
BBA Certified - Certificate No. 20/5728 P1

Specification Clauses

Uniclass 2015 - PR_25_57_65_90
Plastic Sheets
CAWS - J40/145 Loose laid weldable polyethylene gas retardant damp proofing
J40/140 loose laid plastics or rubber sheet gas retardant damp proofing
D21/350 Gas retardant membrane

Certifications



Please Scan



Rev 2024

Accessory Products

- GP[®]1 SAM
- GP[®] DPC
- 300TT
- GP[®] Tape
- GP[®] Lap Tape



Standard Detail - Ground Bearing Raft Slab

NB- All DPC's & membranes interrupting masonry bed joints are required to be bedded above and below with mortar.

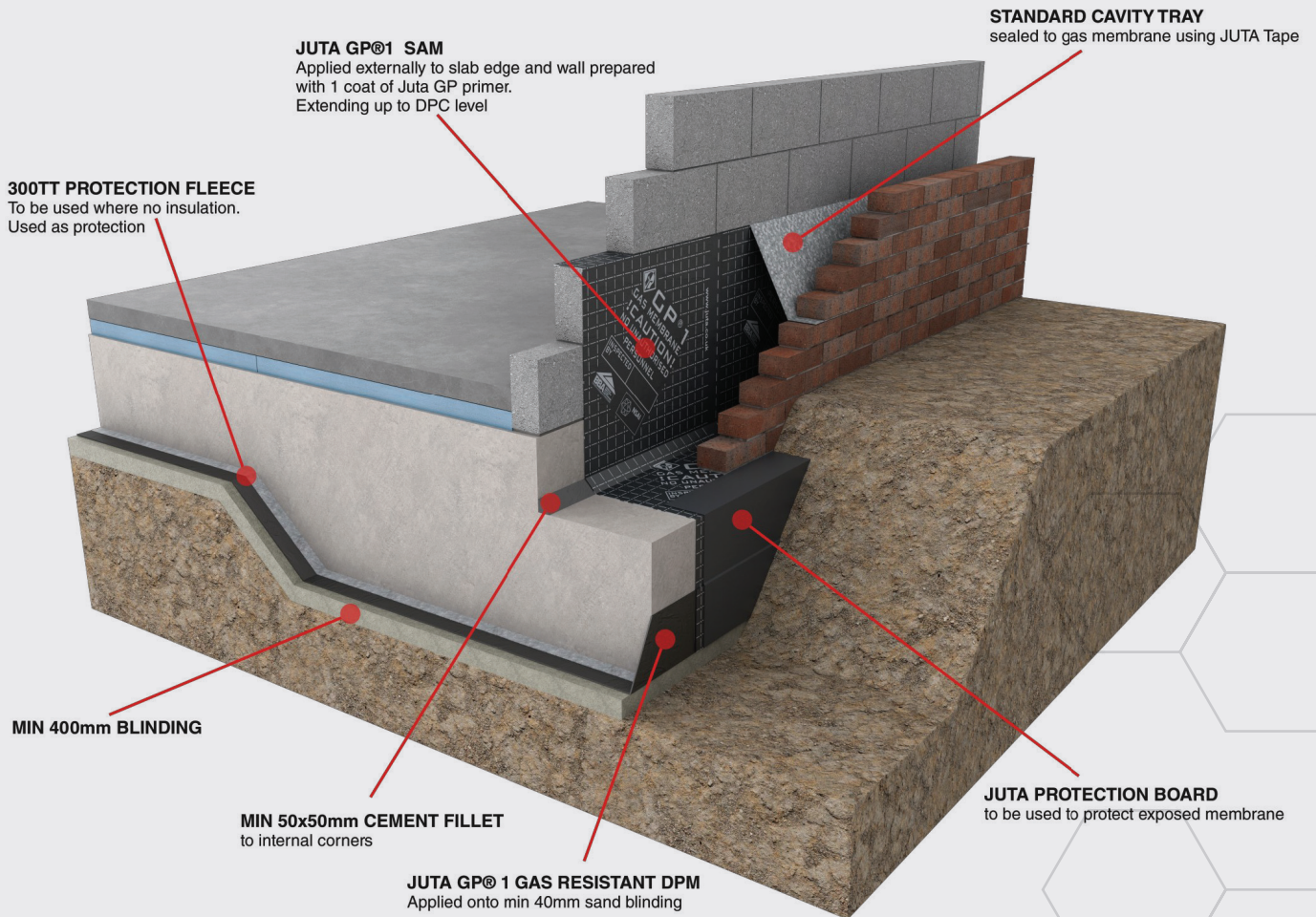

Various typical details available on request. Please contact **technical@juta.co.uk** for further information



Standard Detail - Ground Bearing Slab

NB- All DPC's & membranes interrupting masonry bed joints are required to be bedded above and below with mortar.

300TT PROTECTION FLEECE
To be used where no insulation.
Used as protection

STANDARD CAVITY TRAY
sealed to gas membrane using JUTA Tape

BLINDING

JUTA GP DPC
Juta GP1 can be used as the DPC providing there is no lateral shear as per BS8215:1991. If lateral shear is a design consideration then Juta GP DPC to be used

JUTA GP® TAPE
Taped joint or heat welded seam joint

JUTA GP® 1 GAS RESISTANT DPM
Applied onto min 400mm sand blinding

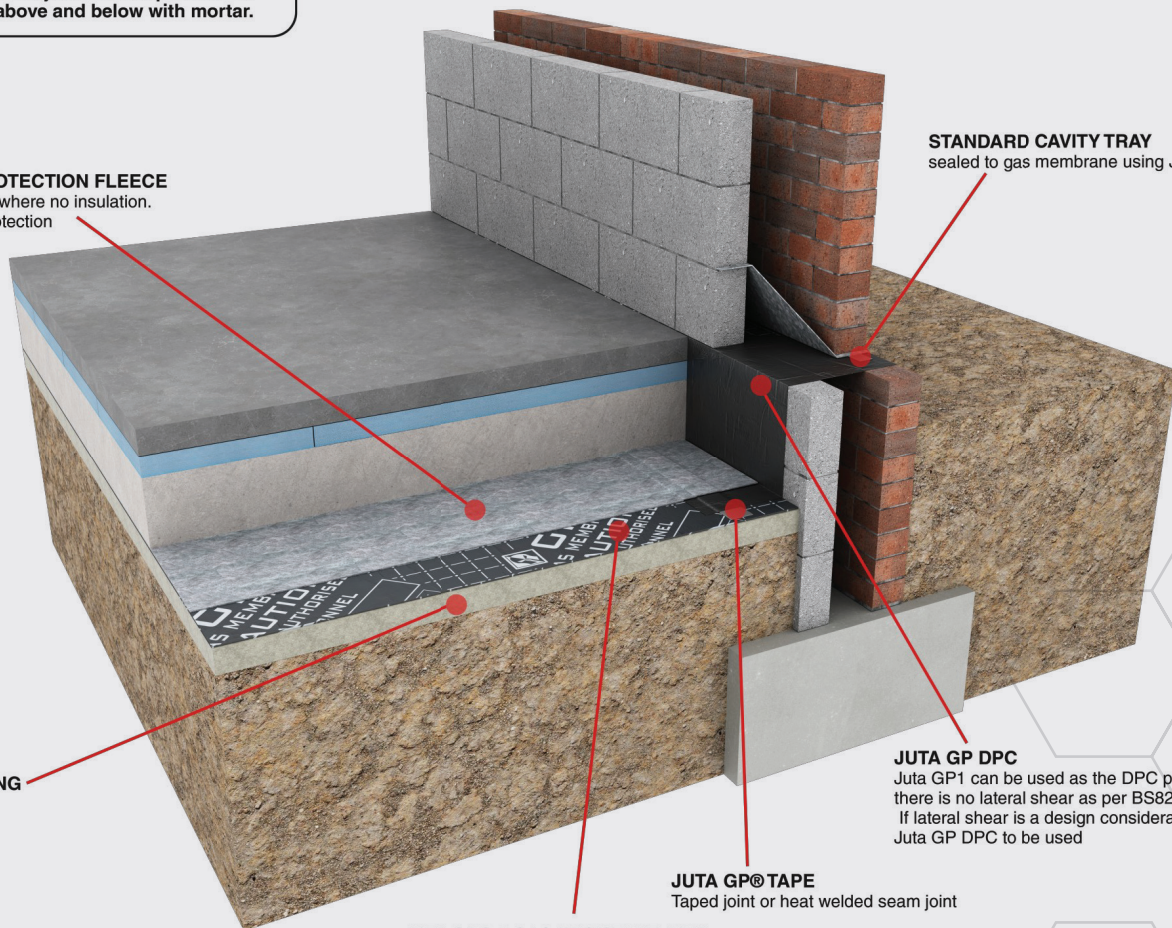

Various typical details available on request. Please contact technical@juta.co.uk for further information



Standard Detail - Ground Block & Beam Flooring

NB- All DPC's & membranes interrupting masonry bed joints are required to be bedded above and below with mortar.

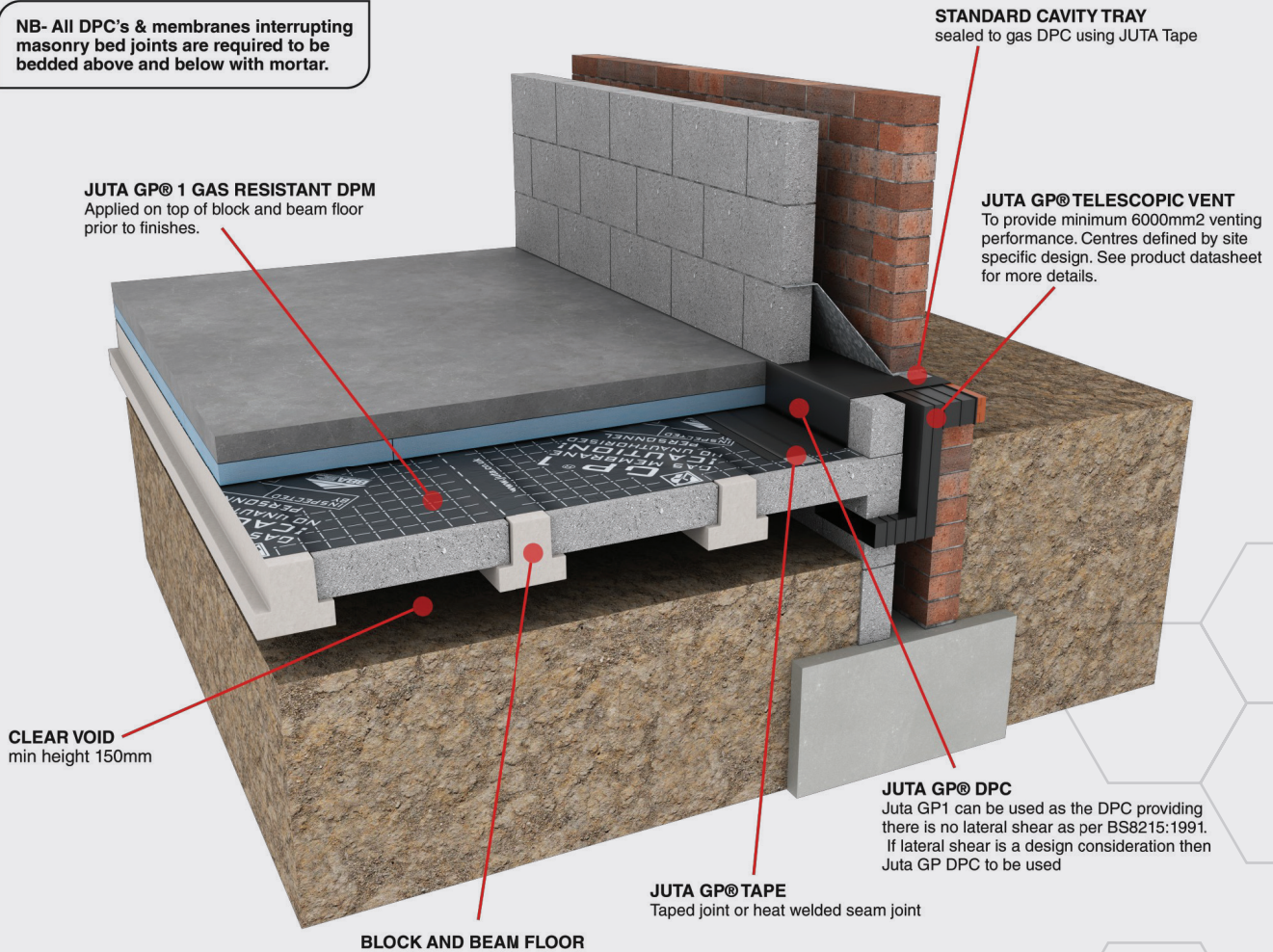

JUTA GP[®] 1 GAS RESISTANT DPM
Applied on top of block and beam floor prior to finishes.

CLEAR VOID
min height 150mm

BLOCK AND BEAM FLOOR

JUTA GP[®] TAPE
Taped joint or heat welded seam joint

JUTA GP[®] DPC
Juta GP1 can be used as the DPC providing there is no lateral shear as per BS8215:1991. If lateral shear is a design consideration then Juta GP DPC to be used

STANDARD CAVITY TRAY
sealed to gas DPC using JUTA Tape

JUTA GP[®] TELESCOPIC VENT
To provide minimum 6000mm² venting performance. Centres defined by site specific design. See product datasheet for more details.

Various typical details available on request. Please contact **technical@juta.co.uk** for further information