



GP[®]1 SAM

GP[®]1 SAM, the gas protection self adhesive membrane, is a bituminous gas proof and water proof sheet, composed of self-adhesive SBS polymer modified bitumen incorporating GP[®] 1 with an upper surface finish of black reinforced LDPE, and a lower surface finish of siliconized release film.

Features and benefits:

- High quality reinforced membrane.
- Low permeability to hydrocarbon and VOC vapours, carbon dioxide, methane and radon.
- Complies with latest codes of practice as published by the BRE and CIRIA, and BS 8485.

Can be used on any site in accordance with BS8485:2015 and NHBC requirements where carbon dioxide, methane or radon is present up to and including CIRIA 665 SITUATION 6. The barrier is sufficiently resistant to the ingress of harmful gasses into a building. On more heavily contaminated sites a passive or active venting system may be required to dilute the gasses down to acceptable levels and specific design advice should be sought.

Physical Properties

Thickness	1.2 mm
Width	0.3 m or 0.9 m
Length	20 m
Weight	1100 g/m ²

Gas Permeability

Methane	< 0.68
Carbon Dioxide	< 2.81
Radon	8.0 x 10 ⁻¹⁵

Compliance and Certification

CE MARK - EN13967:2012 + A1 2019 :2017 Type (A/T)

NHBC Standards Compliant

BS8485:2015 + A1 2019
Accordant BBA Certified -
Certificate No. 22/6076

Specification Clauses

Uniclass 2015:
PR_25_57_08_08 Plastic Sheets

CAWS:
J40/45 Self-adhesive bitumen
gas retardant damp proofing/
tanking

J40/40 Self-adhesive bitumen
damp proofing/ tanking

J40/190 Self-adhesive bitumen
damp proofing/ tanking

J40/180 Self-adhesive bitumen
gas retardant damp proofing/
tanking

Certifications



Please
Scan



Rev 2024

Accessory Products

- GP[®]1
- GP[®] DPC
- 300TT
- GP[®] Tape
- GP[®] Lap Tape



Standard Detail - Ground Bearing Raft Slab

NB- All DPC's & membranes interrupting masonry bed joints are required to be bedded above and below with mortar.

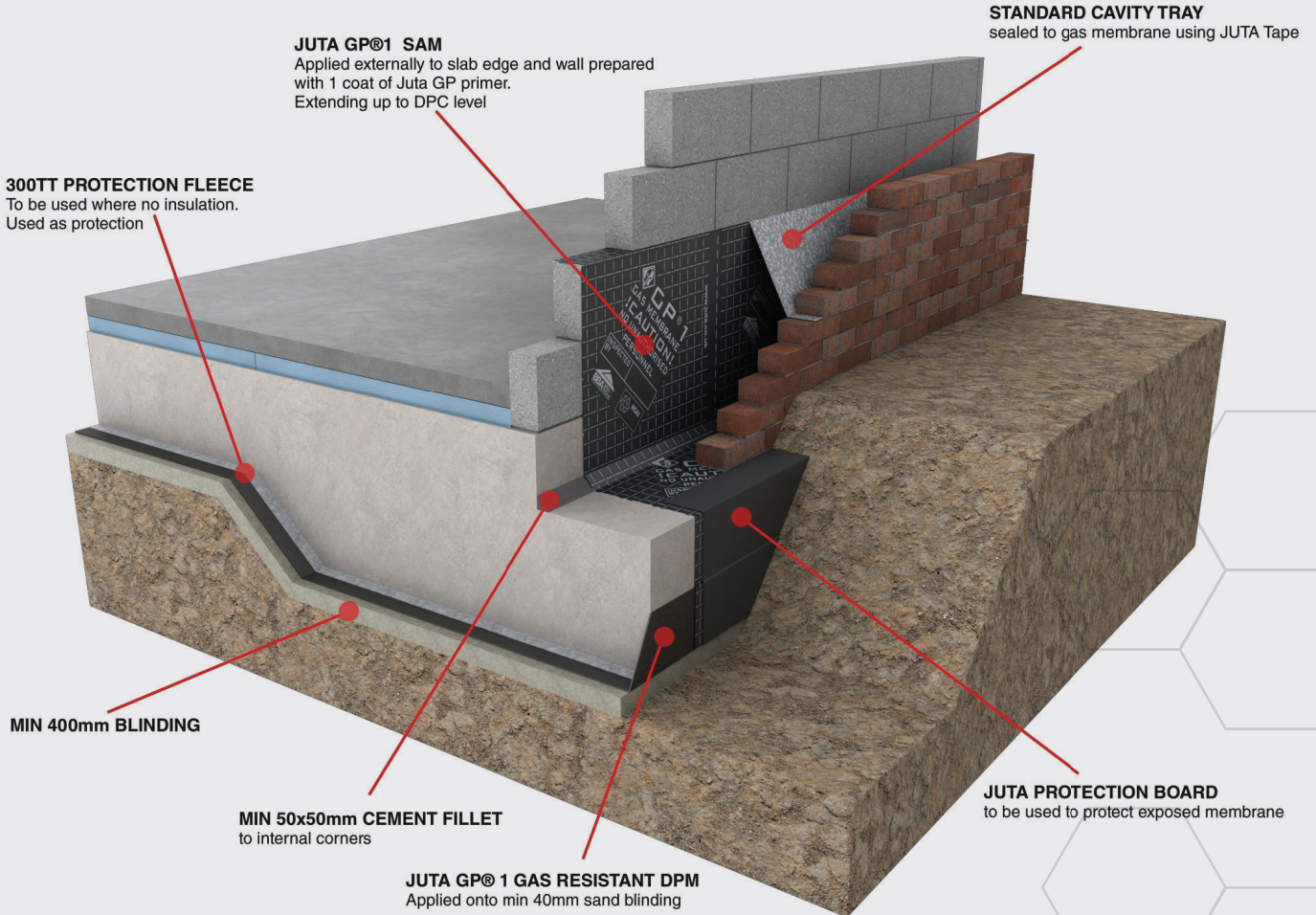

Various typical details available on request. Please contact technical@juta.co.uk for further information



Standard Detail - Ground Bearing Slab

NB- All DPC's & membranes interrupting masonry bed joints are required to be bedded above and below with mortar.

300TT PROTECTION FLEECE
To be used where no insulation.
Used as protection

STANDARD CAVITY TRAY
sealed to gas membrane using JUTA Tape

BLINDING

JUTA GP DPC
Juta GP1 can be used as the DPC providing there is no lateral shear as per BS8215:1991. If lateral shear is a design consideration then Juta GP DPC to be used

JUTA GP¹ TAPE
Taped joint or heat welded seam joint

JUTA GP¹ GAS RESISTANT DPM
Applied onto min 400mm sand blinding

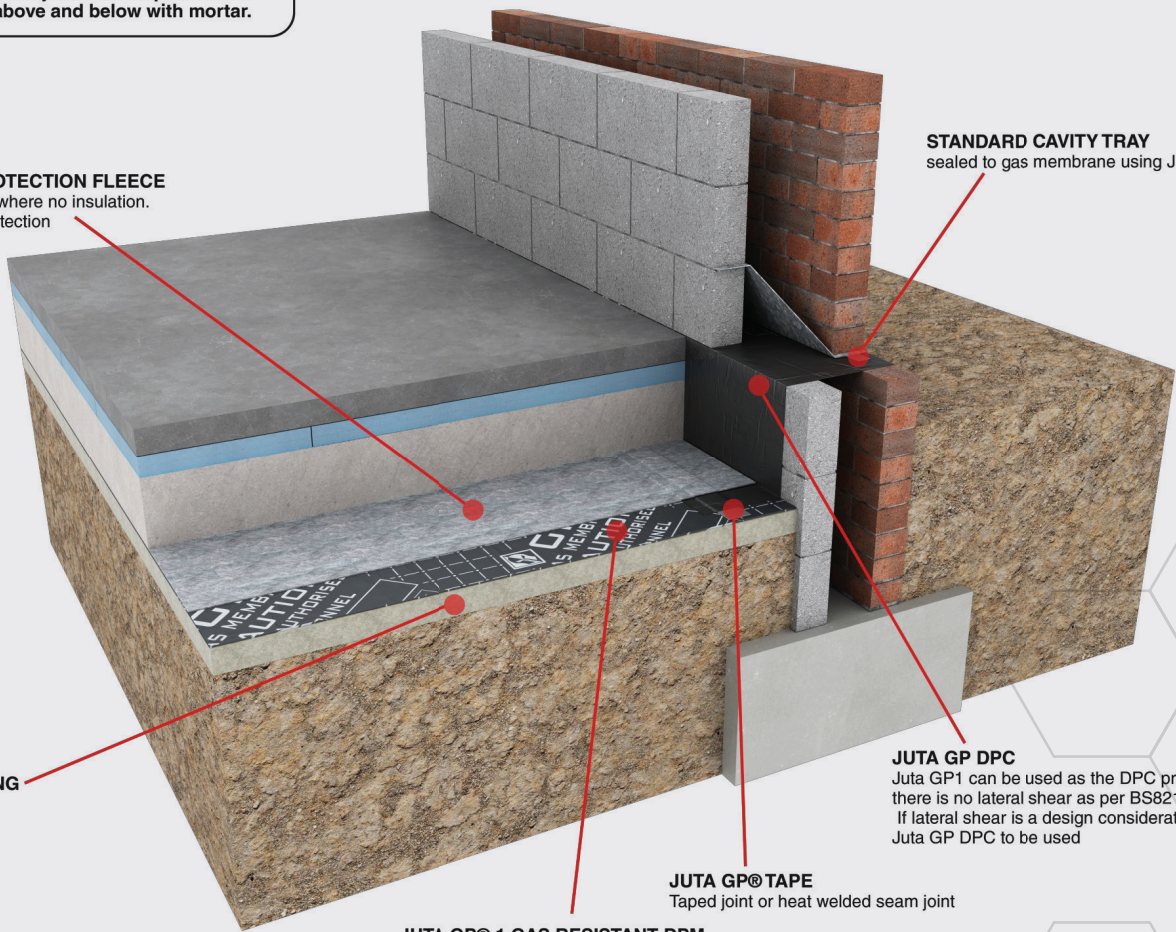

Various typical details available on request. Please contact technical@juta.co.uk for further information



Standard Detail - Ground Block & Beam Flooring

NB- All DPC's & membranes interrupting masonry bed joints are required to be bedded above and below with mortar.

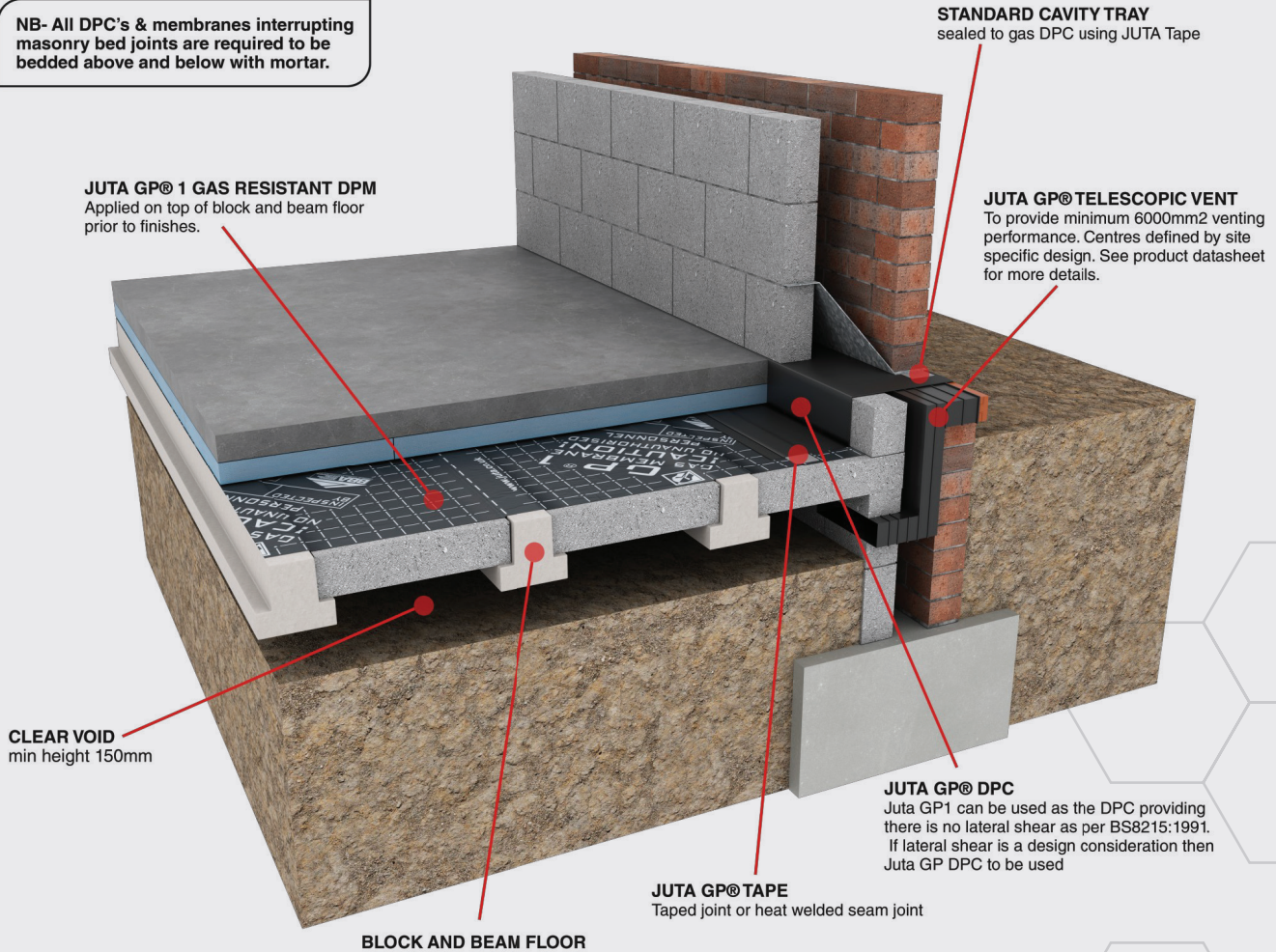

Various typical details available on request. Please contact technical@juta.co.uk for further information